



FLOOD NOTE

THIS PROPERTY IS LOCATED IN A FEDERAL FLOOD AREA AS INDICATED BY F.I.R.M. OFFICIAL FLOOD HAZARD MAPS. COMMUNITY PANEL No. 13121C0069 F (SHADED ZONE "X") EFFECTIVE DATE: SEPTEMBER 18, 2013. FULTON COUNTY, GEORGIA

THE FLOOD INFORMATION ON THIS PLAT HAS BEEN DETERMINED AFTER REVIEW OF MAPS WHICH ONLY APPROXIMATE THE LOCATION OF THE APPLICABLE FLOOD HAZARD AREA. FOR MORE ACCURATE INFORMATION, A SECOND OPINION OF THE APPLICABLE FLOOD HAZARD AREA IS RECOMMENDED. FOR FURTHER INFORMATION CONTACT THE LOCAL DRAINAGE DEPARTMENT, CORPS OF ENGINEERS, AN INSURANCE COMPANY OR APPRAISER.

ZONING INFORMATION

CITY OF JOHNS CREEK - R-4A
 MINIMUM LOT AREA: 12,000 SQUARE FEET
 MINIMUM LOT WIDTH: 85 FEET
 MINIMUM FRONT SETBACK: 35 FEET
 MINIMUM SIDE SETBACK: 7 FEET
 MINIMUM REAR SETBACK: 20 FEET
 MUST BE VERIFIED BY CITY OF JOHNS CREEK PRIOR TO CONSTRUCTION.

RECEIVED

V-22-0016

SEP 23 2022

PLANNING & ZONING

LEGEND

B	DENOTES BUILDING LINE
P	DENOTES PROPERTY LINE
R/W	DENOTES RIGHT-OF-WAY
C	DENOTES CENTERLINE
BC	DENOTES BACK OF CURB
G	DENOTES GUTTER
TW	DENOTES TOP OF WALL
BW	DENOTES BOTTOM OF WALL
X	DENOTES FENCE
RCP	DENOTES REINFORCED CONCRETE PIPE
CMP	DENOTES CORRUGATED METAL PIPE
PP	DENOTES POWER POLE
LP	DENOTES LIGHT POLE
GW	DENOTES GUY WIRE
P	DENOTES POWER LINE
PM	DENOTES POWER METER
PB	DENOTES POWER BOX
FO	DENOTES FIBER OPTIC
A/C	DENOTES AIR CONDITION
CB	DENOTES CABLE BOX
TB	DENOTES TELEPHONE BOX
GM	DENOTES GAS METER
WM	DENOTES WATER METER
WV	DENOTES WATER VALVE
FH	DENOTES FIRE HYDRANT
HW	DENOTES HEADWALL
JB	DENOTES JUNCTION BOX
DI	DENOTES DROP INLET
S	DENOTES SANITARY SEWER LINE
SSMH	DENOTES SANITARY SEWER MANHOLE

SURVEY NOTES

1. STORM SEWER, SANITARY SEWER AND OTHER BURIED UTILITIES MAY HAVE BEEN PAVED OR COVERED OVER. THE LOCATION OF UNDERGROUND UTILITIES AS SHOWN HEREON ARE BASED ON ABOVE GROUND STRUCTURES. UNDERGROUND UTILITIES MAY VARY FROM LOCATIONS SHOWN HEREON. ADDITIONAL BURIED UTILITIES MAY BE ENCOUNTERED. PLEASE CALL ALL LOCAL UTILITY PROVIDERS AND OR 811 FOR FURTHER INFORMATION.
2. SURVEYOR HAS MADE NO INVESTIGATION OR INDEPENDENT SEARCH FOR EASEMENTS OF RECORD, ENCUMBRANCES, RESTRICTIVE COVENANTS, OWNERSHIP TITLE EVIDENCE, OR ANY OTHER FACTS THAT A CURRENT TITLE SEARCH MAY DISCLOSE. FOR NEW PERMITS THE LOCAL ISSUING AUTHORITY MAY REQUIRE ADDITIONAL EASEMENTS NOT SHOWN.
3. THIS PLAT WAS PREPARED FOR THE EXCLUSIVE USE OF THE PERSON, PERSONS OR ENTITY NAMED HEREON. THIS PLAT DOES NOT EXTEND TO ANY UNNAMED PERSON, PERSONS, OR ENTITY WITHOUT THE EXPRESS RECERTIFICATION OF THE SURVEYOR NAMING SUCH PERSON, PERSONS OR ENTITY.
4. THE FIELD DATA UPON WHICH THIS PLAT IS BASED WAS GATHERED BY AN OPEN TRAVERSE AND HAS A CALCULATED POSITIONAL TOLERANCE OF 0.03 FEET. THIS PLAT HAS BEEN CALCULATED FOR CLOSURE AND IS FOUND TO BE ACCURATE WITHIN ONE FOOT IN 167,376 FEET. A GEOMAX ZOOM 90 SERIES ROBOTIC TOTAL STATION WITH CARLSON SURVEY 2 DATA COLLECTOR WERE USED IN THE COLLECTION OF FIELD DATA.
5. BASIC OF BEARINGS: PB 152 PG 62
6. THIS PROPERTY IS SUBJECT TO CURRENT ZONING REGULATIONS AND RESTRICTIONS.
7. ALL REBARS SET ARE 1/2" REBARS UNLESS OTHERWISE NOTED.
8. THE EXISTENCE, SIZE, AND LOCATION OF IMPERVIOUS BUFFERS ARE SUBJECT TO FINAL DETERMINATION BY THE LOCAL ISSUING AUTHORITY, CITY, OR COUNTY.
9. THE DWELLING SHOWN HEREON IS OUTSIDE THE FLOOD HAZARD AREA SHOWN ON THE RECORDED PLAT.

**Know what's below.
Call before you dig.**

Existing Square Footage inside the 75' Impervious surface setback is 305 SQFT

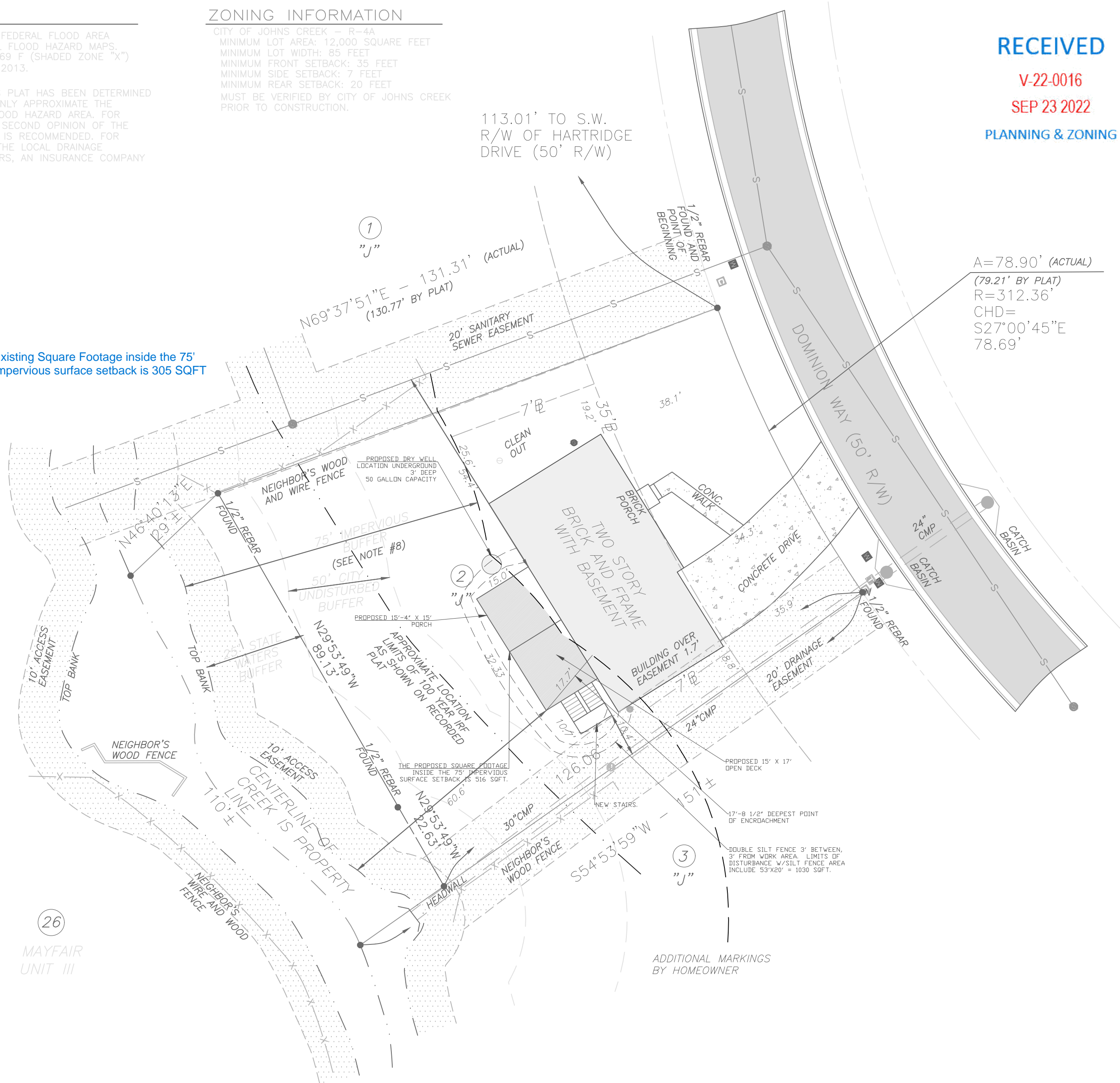

A=78.90' (ACTUAL)
 (79.21' BY PLAT)
 R=312.36'
 CHD=
 S27°00'45"E
 78.69'

26
 MAYFAIR
 UNIT III

ADDITIONAL MARKINGS
 BY HOMEOWNER

NO.	REVISIONS	DATE
1	ADDED ZONING	6-27-22
2	ADDED 50' UNDISTURBED BUFFER PER CITY	7-18-2022

F:\AutoCad\Rick's Notes Services Seal 2\mclung logo.png

McClung Surveying Services, Inc.
 4833 South Cobb Drive Suite 200
 Smyrna, Georgia 30080 (770) 434-3383
 www.mclungsurveying.com Certificate of Authorization #LSF000752

SURVEY FOR
 MEGHAN RADEMACHER
 JOHN RADEMACHER

9500 DOMINION WAY
 JOHNS CREEK, GEORGIA

TOTAL AREA= 0.355± ACRES
 OR 15,448± SQ. FT.

20' 10' 0' 20' 40'
 SCALE IN FEET

LOT 2, BLOCK "J"
 HARTRIDGE SUBDIVISION
 UNIT 1

LAND LOT 893
 1ST DISTRICT 2ND SECTION
 DEKALB COUNTY, GEORGIA
 PLAT PREPARED: 6-20-22
 FIELD: 6-11-22 SCALE: 1"=20'

JOB#RADEMACHERSURVEY

PB 152
 PG 62