



## Land Use Petition for RZ-19-005

<b>CASE NUMBERS:</b>	RZ-19-005 VC-19-005-01, VC-19-005-02
<b>CURRENT ZONING:</b>	C-1 (Community Business District) Conditional
<b>PROPOSED ZONING:</b>	C-1 (Community Business District) Conditional
<b>LOCATION:</b>	5805 State Bridge Road, #50 & A-600 & P
<b>ACREAGE:</b>	16.24 acres
<b>LAND USE PLAN DESIGNATION:</b>	Medlock
<b>DISTRICT/SECTION/LANDLOT(S):</b>	1 <sup>st</sup> District, 1 <sup>st</sup> Section, Land Lots 330 and 331
<b>PROJECT DESCRIPTION:</b>	Changing in zoning conditions to allow for a Discount Tire store of 8,192 square feet with two concurrent variances: VC-19-005-01: allow for a flat roof for the proposed building VC-19-005-02: reduce required parking space from 41 to 25 spaces
<b>APPLICANT:</b>	Discount Tire Company 20225 North Scottsdale Road Scottsdale, AZ 85255 Contact: David C. Kirk Phone: 404.885.3415
<b>OWNERS:</b>	Medlock Corners Associates LLC 114 Chestnut Street, 5 <sup>th</sup> floor Philadelphia, PA 19106
<b>CASE PLANNER:</b>	Jeannie Peyton 678.512.3298 <a href="mailto:Jeannie.Peyton@johnscreekgov">Jeannie.Peyton@johnscreekgov</a>

# Aerial Map



## Community Development



# Zoning Map

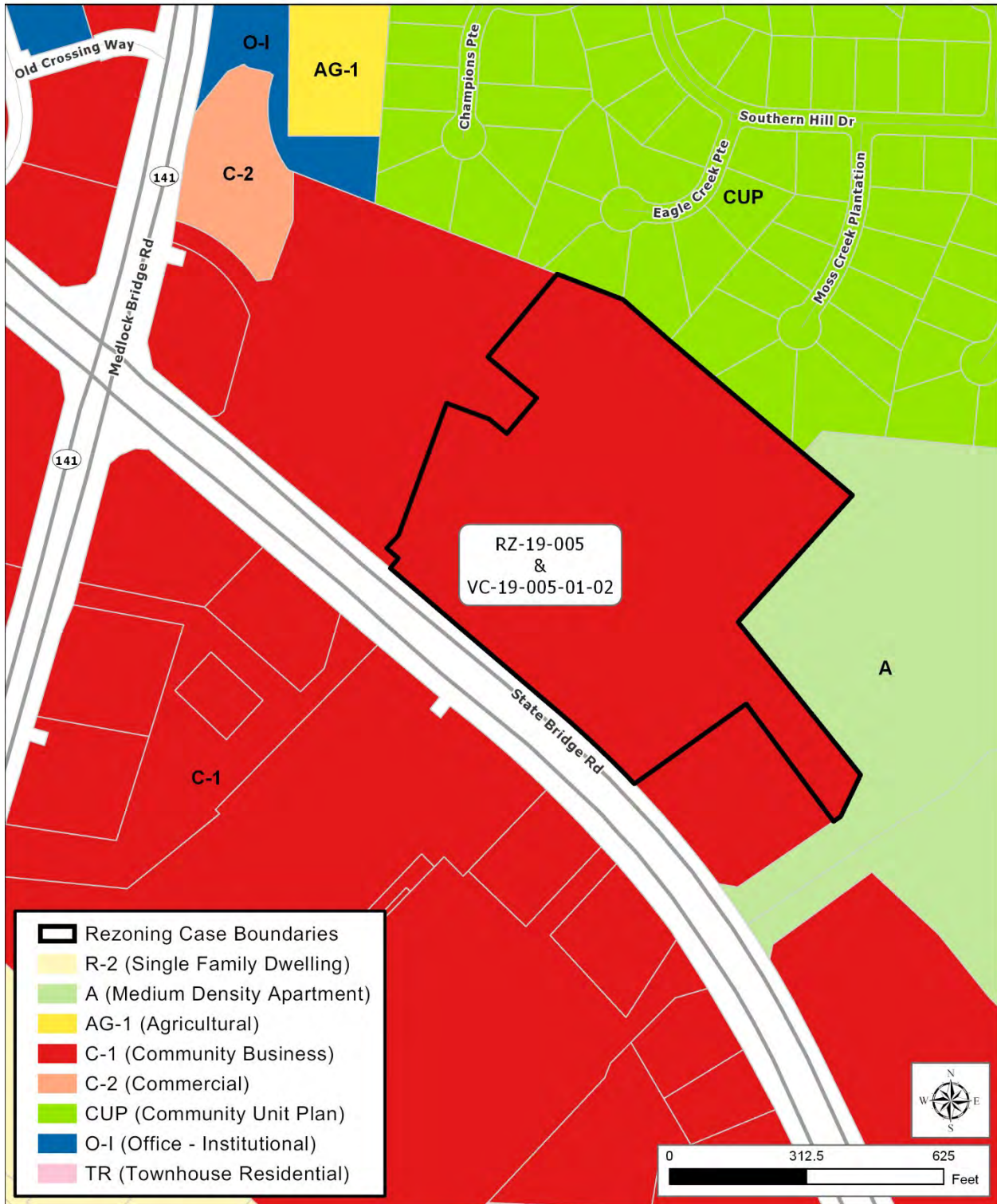

## Community Development

# 2018 Comprehensive Plan Community Area Map

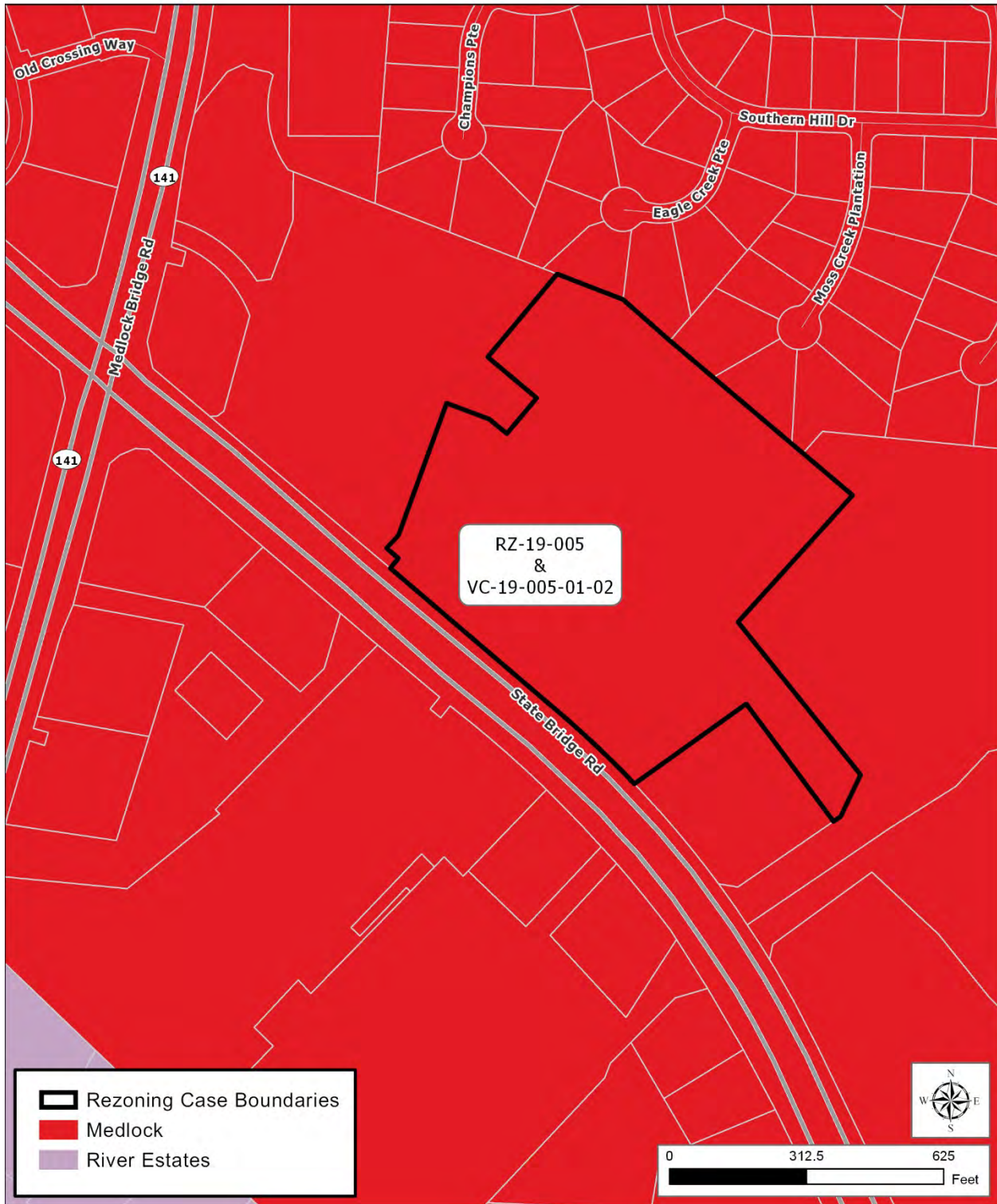

## Community Development